

ITEM	PART NO.	DESCRIPTION	QTY.	WEIGHT
1	WBBS2.01	FOOT WELDMENT	1	9.81 LBS
2	WBBSH	HARDWARE KIT (ITEM# 3 & 4)	1	
3	GUB4355	1/2"-13 UNC X 3-5/8" X 5" GALV U-BOLT KIT	2	0.72 LBS
4	MT280	5/8" X 6" WEDGE ANCHOR KIT	4	0.64 LBS

REVISIONS				
REV.	ZONE	DESCRIPTION	BY	DATE
A		INITIAL RELEASE	ACG	10/18/13

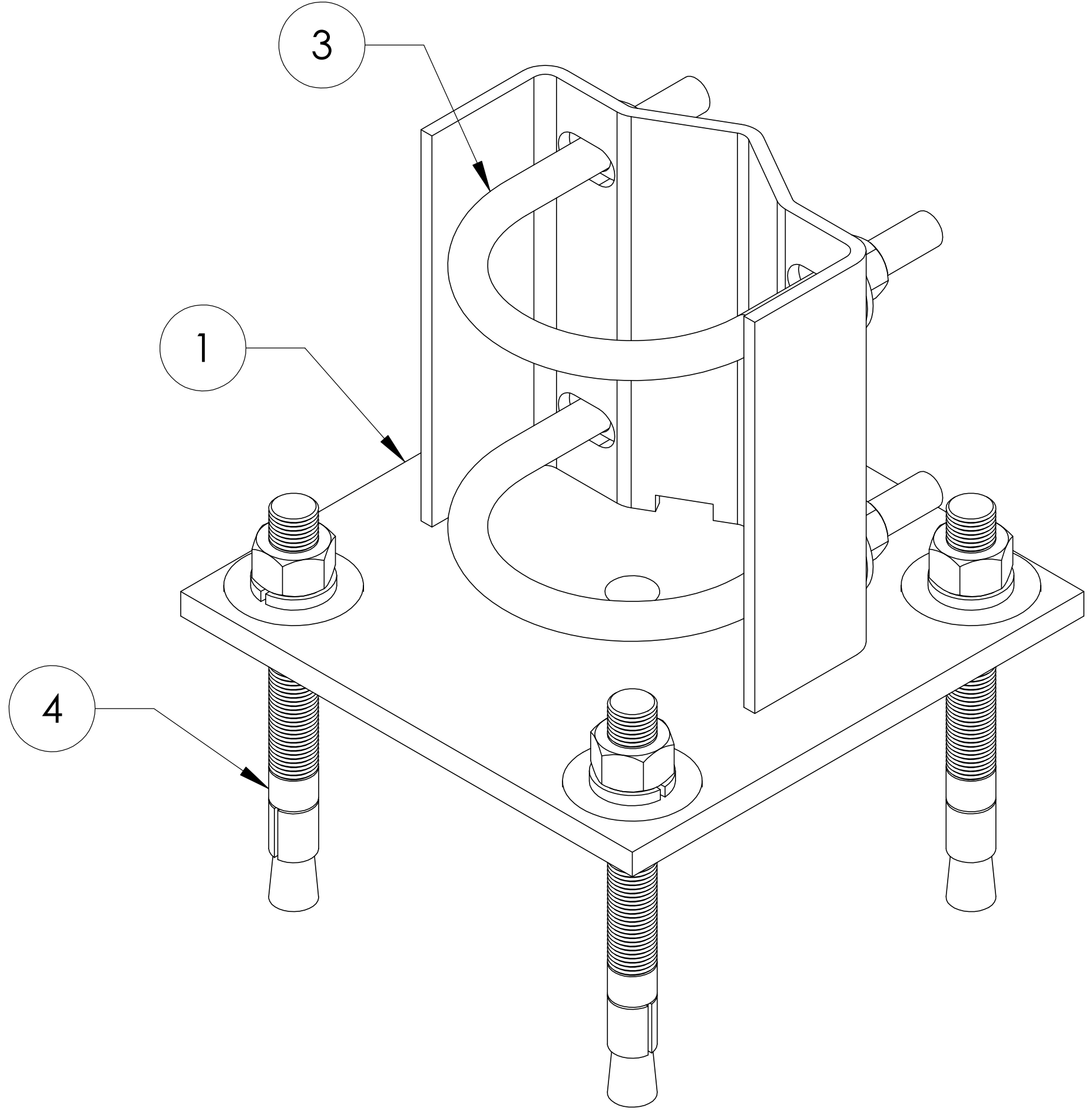
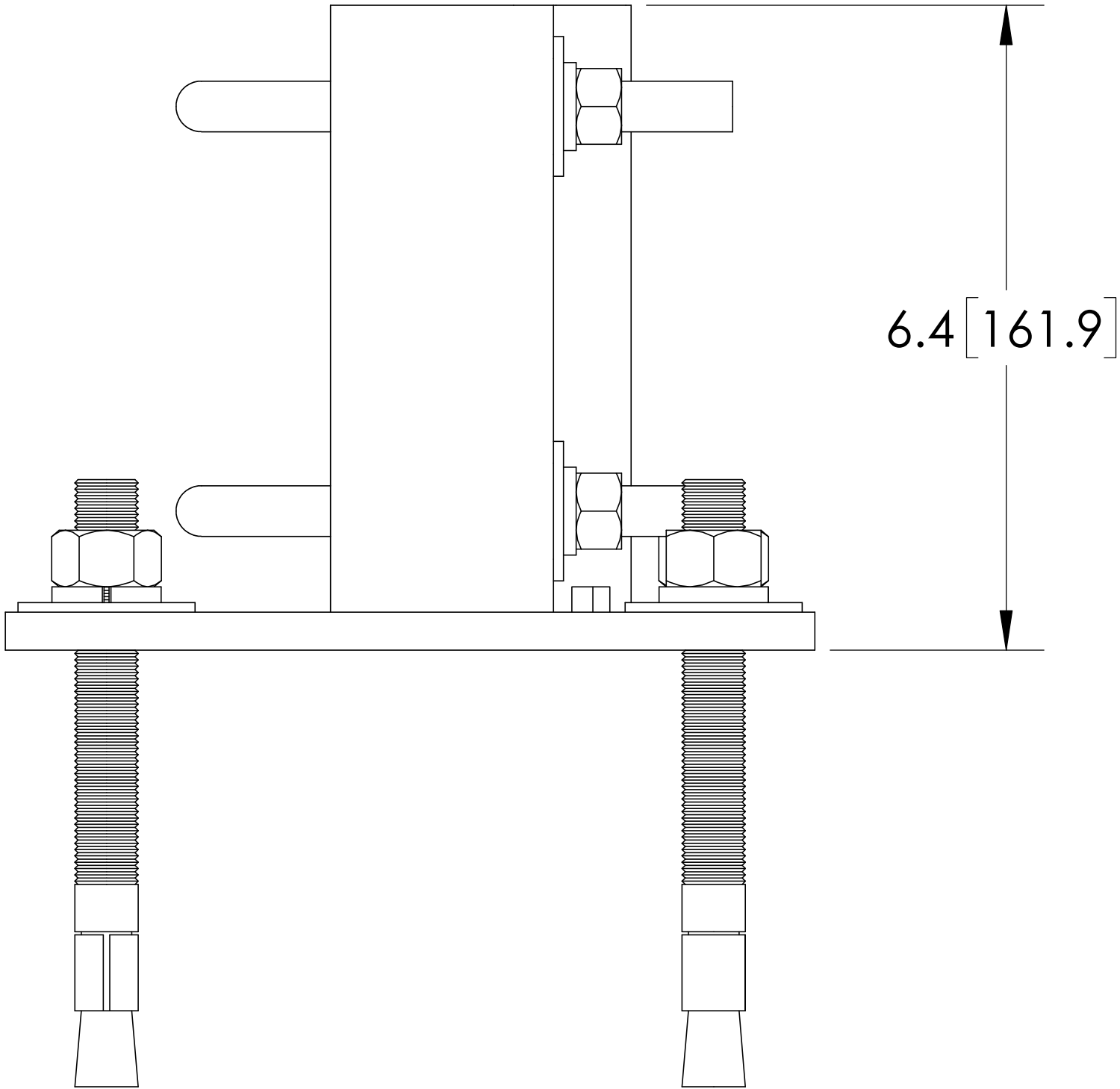
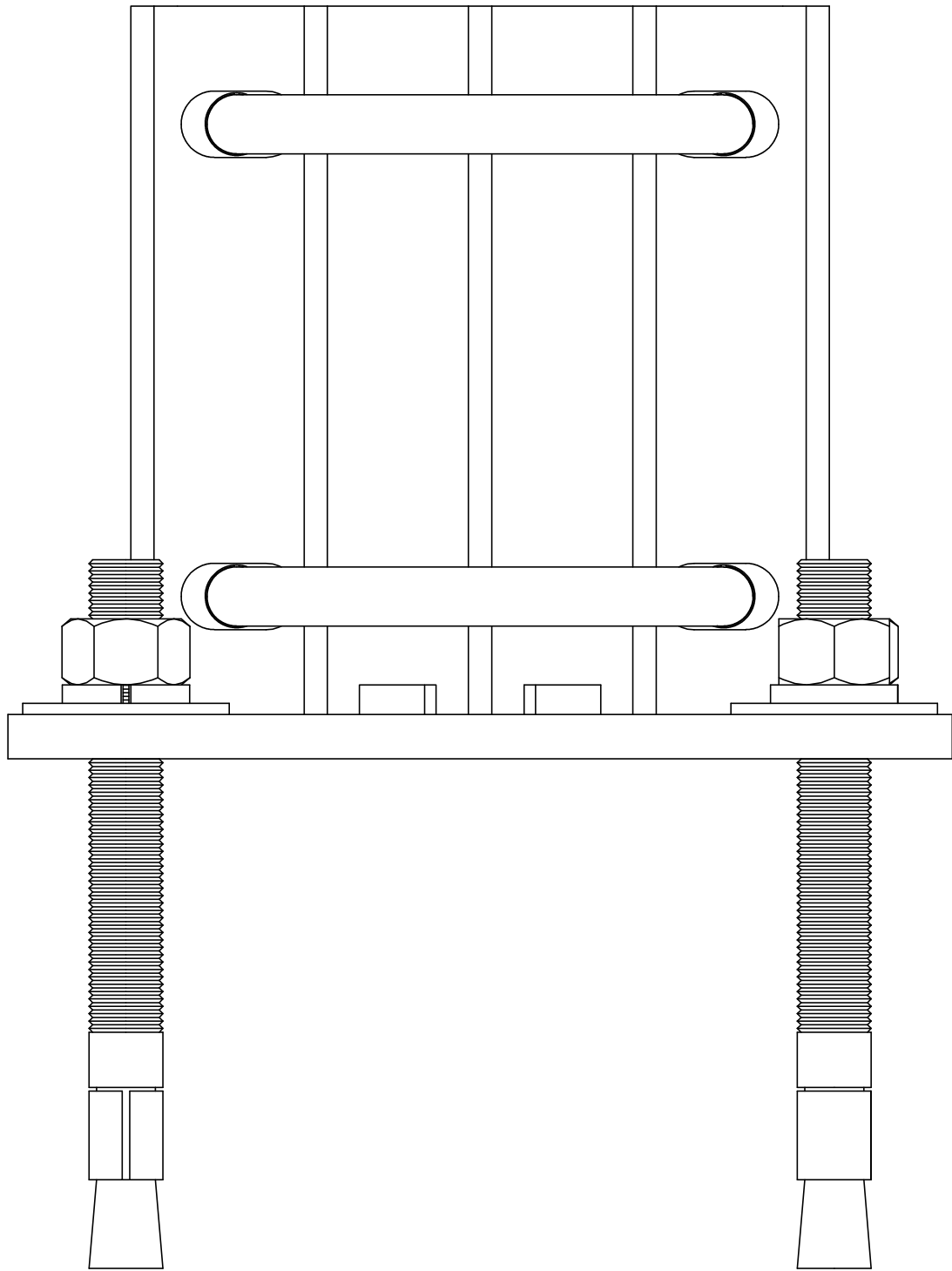
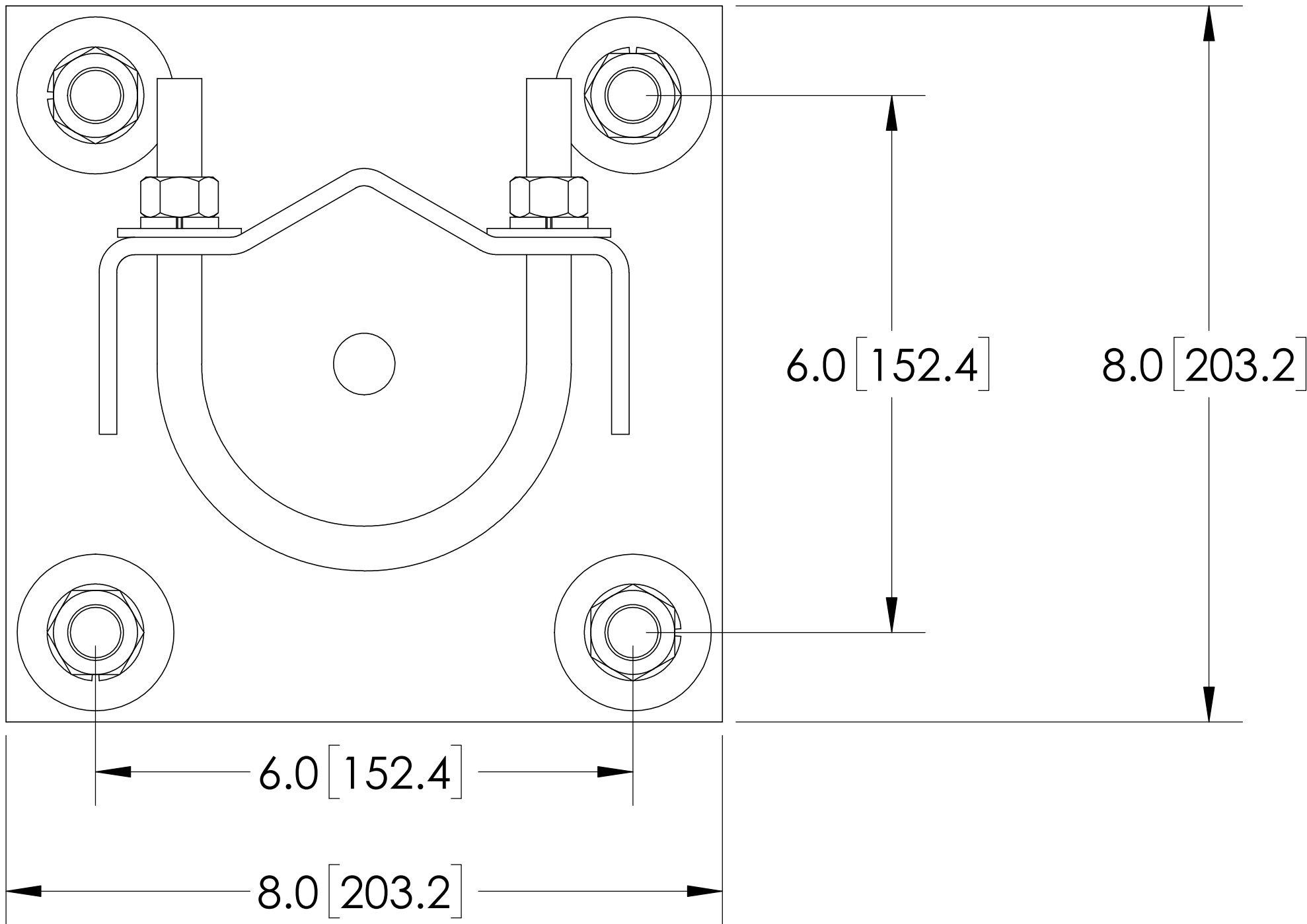

- NOTES:
- ALL METRIC DIMENSIONS ARE IN BRACKETS.
 - STAMP PART IDENTIFICATION NUMBER.
 - WELDING WORKMANSHIP PER AWS D1.1, TABLE 6.1.

These drawings and specifications are proprietary property and may be used only for the specific purpose authorized in writing.

ALL DIMENSIONS ARE IN INCHES U.O.S.
TOLERANCES UNLESS OTHERWISE SPECIFIED:
.X = ± .06 ANGLES ±2'
.XX = ± .03 FRACTIONS ±1/32
.XXX = ± .010

REMOVE BURRS AND BREAK EDGES .005

DO NOT SCALE THIS PRINT

DRAWN BY: ACG	SHEET: 1 of 1	PART NUMBER: FM-WBBS2
CHECKED BY: MKV	SCALE: NTS	DESCRIPTION: BASE SHOE FOR \varnothing 3-1/2" O.D. PIPE
DATE: 10/20/21	MATERIAL: ASTM A1011/A1018 Gr.36	DRAWING TYPE: ASSEMBLY DRAWING
REVISION: A	FINISH: ASTM A123	
	WEIGHT: 14.18 LBS	